

FLOWRISE PCP DATA SHEET

| PUMP | Metric | Imperial |
|----------------------------------|----------------------------|----------------|
| Pump Model | 90K800 RG | |
| Pump Pressure Rating* | 8,000 kPa | 1,160 psi |
| Pump Nominal Capacity | 0.90 m ³ /d/RPM | 5.66 bbl/d/RPM |
| Pump Validated Capacity | 0.86 m ³ /d/RPM | 5.41 bbl/d/RPM |
| Pump Recommended Maximum Speed** | 500 RPM | |
| PUMP DISCHARGE | | PUMP INTAKE |

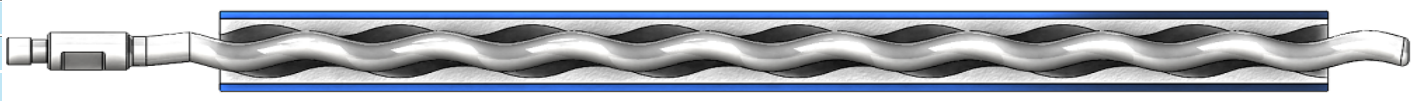

| STATOR | Metric | Imperial |
|--|----------------|------------|
| Stator Type | RG | |
| Stator Assembly Max. O.D. | 114.3 mm | 4.50 inch |
| Recommended Minimum Casing Drift Diameter | 118.3 mm | 4.66 inch |
| Recommended Stator Transition Joint Min I.D.**** | N/A | N/A |
| Stator Length**** | 7.80 m | 25.59 ft |
| Stator Weight | 247.7 kg | 545.6 lb |
| Stator Discharge Connection | 3 1/2" EUE Box | |
| Stator Inlet Connection | 3 1/2" EUE Box | |
| Pump Number of Stator Elements | 2.00 | |
| Stator Material | Carbon Steel | |
| Stator Material Strength (min.UTS) | 480 MPa | 70,000 psi |
| Stator Elastomer Options | HNH , HNS | |

| ROTOR | Metric | Imperial |
|---|---|------------|
| Rotor Minor Nominal Diameter (D) | 41.6 mm | 1.64 inch |
| Rotor Major Nominal Diameter (D+2E) | 57.1 mm | 2.25 inch |
| Recommended Minimum Tubing Drift Diameter | 59.2 mm | 2.33 inch |
| Rotor Head Diameter | 57.2 mm | 2.25 inch |
| Rotor Max Orbit Diameter | 73.2 mm | 2.88 inch |
| Rotor Total Length | 8.32 m | 27.28 ft |
| Rotor Helix Length | 8.10 m | 26.59 ft |
| Rotor Weight | 88.17 kg | 194.21 lb |
| Rotor Head Connection | 1 1/8" API Pin | |
| Recommended Rotor Coupling OD | 57.2 mm | 2.25 inch |
| Rotor Material | Alloy Steel | |
| Rotor Material Strength (min.UTS) | 585 MPa | 85,000 psi |
| Rotor Coating Options | Hard Chrome | |
| ROTOR SPACE OUT OPTIONS | | |
| Rotor Top Landing Device | Top Tag | |
| Rotor Bottom Landing Device | Standard, Extended - Blind/ Slotted/ Notched Tag Nipple | |
| Bottom Landing Device Connection (Inlet) | 3 1/2 EUE Pin | |

FLOWRISE PCP CURVES - 90K800 RG

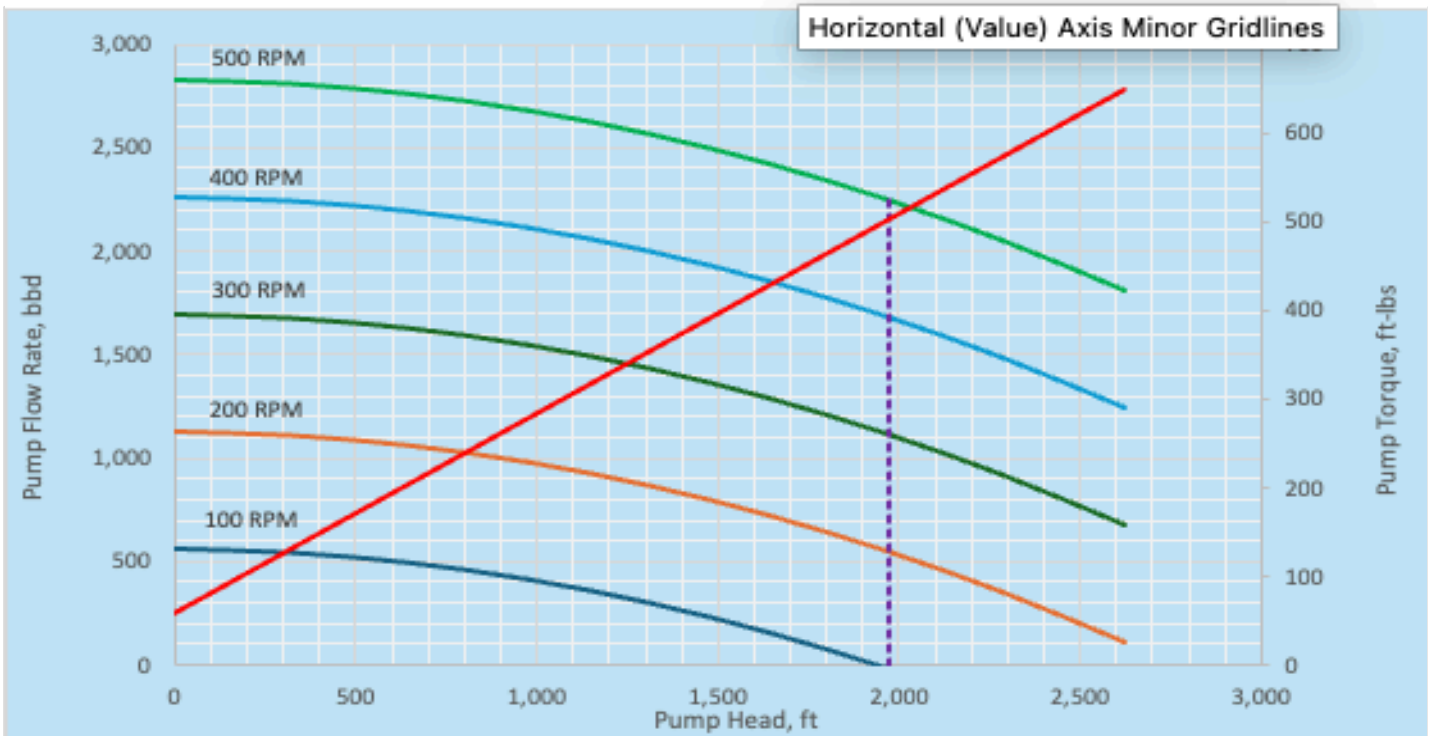
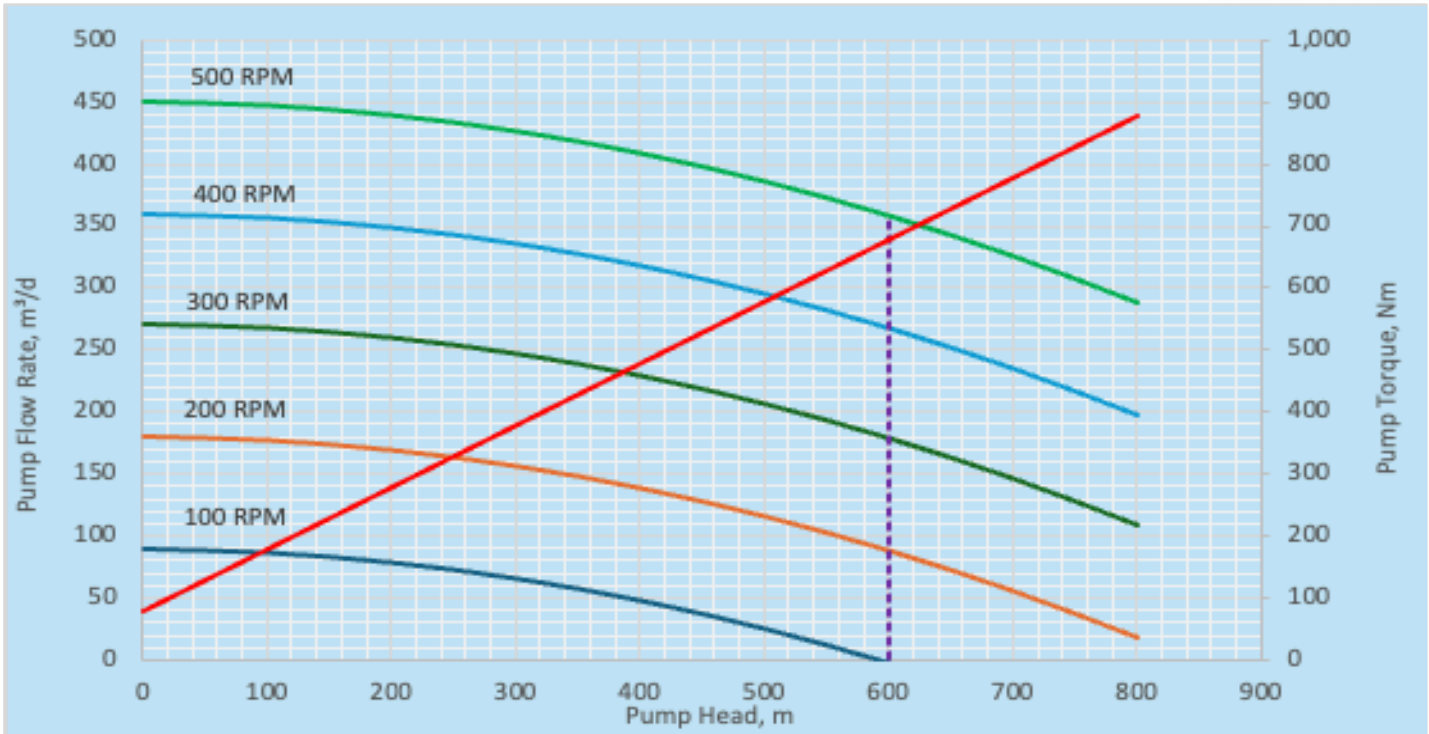

FLOWRISE PCP DATA SHEET

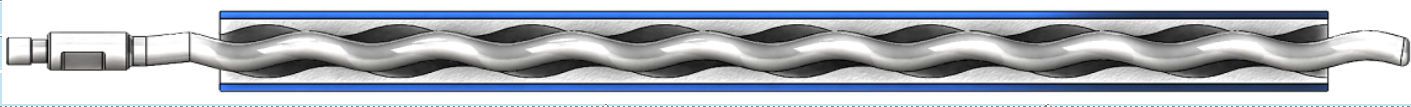
| PUMP | Metric | Imperial |
|---|---|----------------|
| Pump Model | 90K1000 RG | |
| Pump Pressure Rating* | 10,000 kPa | 1,450 psi |
| Pump Nominal Capacity | 0.90 m ³ /d/RPM | 5.66 bbl/d/RPM |
| Pump Validated Capacity | 0.86 m ³ /d/RPM | 5.41 bbl/d/RPM |
| Pump Recommended Maximum Speed** | 500 RPM | |
| PUMP DISCHARGE | | PUMP INTAKE |
|  | | |
| STATOR | Metric | Imperial |
| Stator Type | RG | |
| Stator Assembly Max. O.D. | 114.3 mm | 4.50 inch |
| Recommended Minimum Casing Drift Diameter | 118.3 mm | 4.66 inch |
| Recommended Stator Transition Joint Min I.D.**** | N/A | N/A |
| Stator Length**** | 9.75 m | 31.99 ft |
| Stator Weight | 309.6 kg | 681.9 lb |
| Stator Discharge Connection | 3 1/2" EUE Box | |
| Stator Inlet Connection | 3 1/2" EUE Box | |
| Pump Number of Stator Elements | 2.50 | |
| Stator Material | Carbon Steel | |
| Stator Material Strength (min.UTS) | 480 MPa | 70,000 psi |
| Stator Elastomer Options | HNH , HNS | |
| ROTOR | Metric | Imperial |
| Rotor Minor Nominal Diameter (D) | 41.6 mm | 1.64 inch |
| Rotor Major Nominal Diameter (D+2E) | 57.1 mm | 2.25 inch |
| Recommended Minimum Tubing Drift Diameter | 59.2 mm | 2.33 inch |
| Rotor Head Diameter | 57.2 mm | 2.25 inch |
| Rotor Max Orbit Diameter | 73.2 mm | 2.88 inch |
| Rotor Total Length | 10.26 m | 33.68 ft |
| Rotor Helix Length | 10.05 m | 32.99 ft |
| Rotor Weight | 108.65 kg | 239.32 lb |
| Rotor Head Connection | 1 1/8" API Pin | |
| Recommended Rotor Coupling OD | 57.2 mm | 2.25 inch |
| Rotor Material | Alloy Steel | |
| Rotor Material Strength (min.UTS) | 585 MPa | 85,000 psi |
| Rotor Coating Options | Hard Chrome | |
| ROTOR SPACE OUT OPTIONS | | |
| Rotor Top Landing Device | Top Tag | |
| Rotor Bottom Landing Device | Standard, Extended - Blind/ Slotted/ Notched Tag Nipple | |
| Bottom Landing Device Connection (Inlet) | 3 1/2 EUE Pin | |

FLOWRISE PCP CURVES - 90K1000 RG

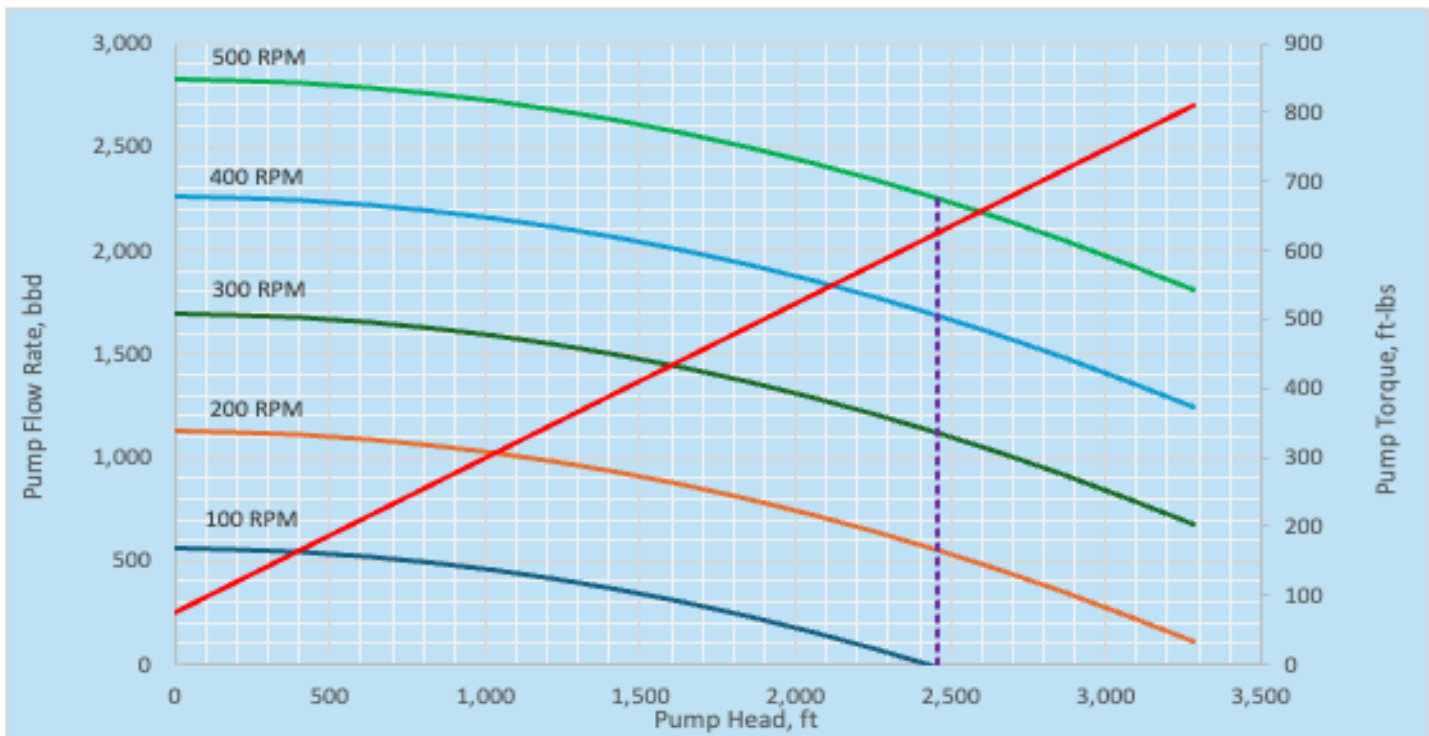
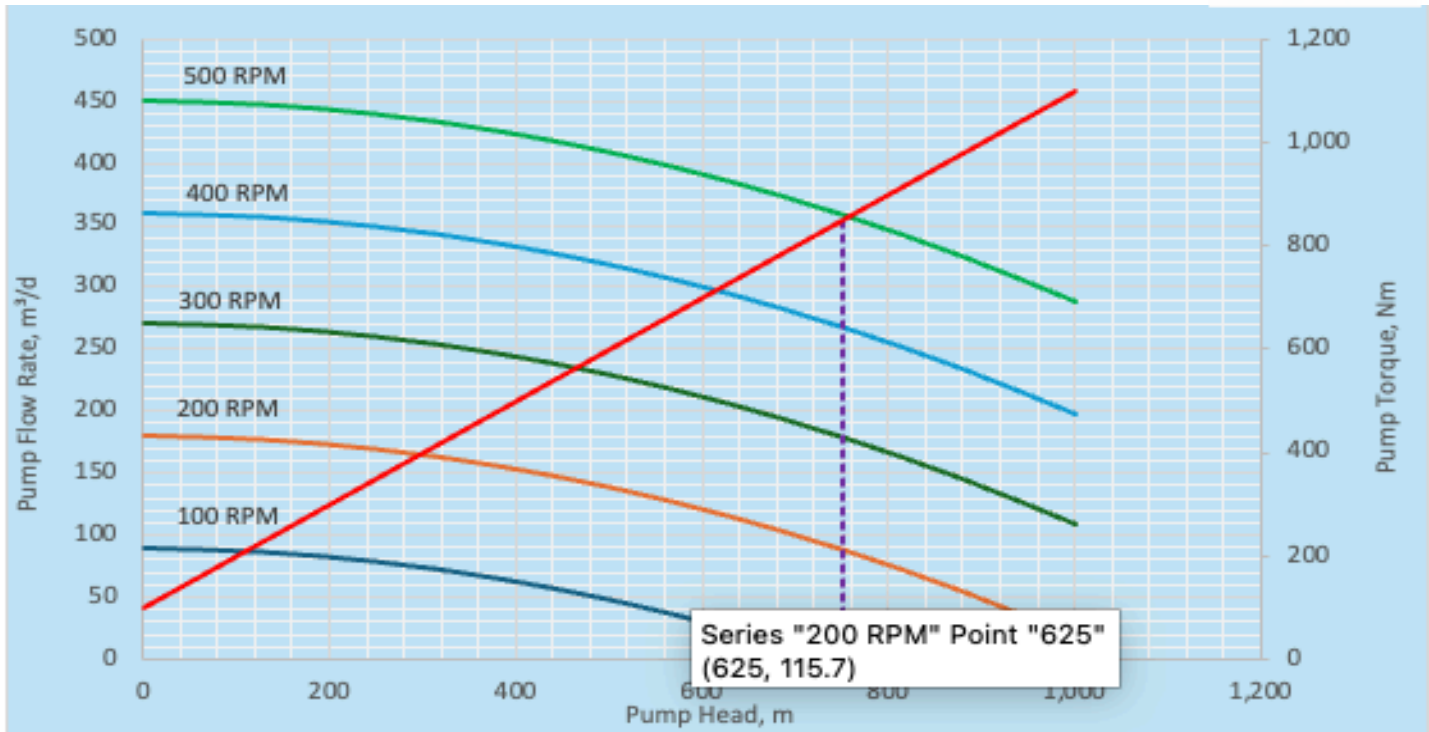

FLOWRISE PCP DATA SHEET

| PUMP | Metric | Imperial |
|----------------------------------|----------------------------|----------------|
| Pump Model | 90K1600 RG | |
| Pump Pressure Rating* | 16,000 kPa | 2,320 psi |
| Pump Nominal Capacity | 0.90 m ³ /d/RPM | 5.66 bbl/d/RPM |
| Pump Validated Capacity | 0.86 m ³ /d/RPM | 5.41 bbl/d/RPM |
| Pump Recommended Maximum Speed** | 500 RPM | |
| PUMP DISCHARGE | | PUMP INTAKE |

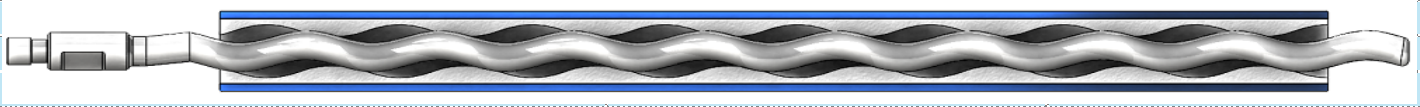

| STATOR | Metric | Imperial |
|--|----------------|------------|
| Stator Type | RG | |
| Stator Assembly Max. O.D. | 114.3 mm | 4.50 inch |
| Recommended Minimum Casing Drift Diameter | 118.3 mm | 4.66 inch |
| Recommended Stator Transition Joint Min I.D.**** | N/A | N/A |
| Stator Length**** | 15.60 m | 51.18 ft |
| Stator Weight | 495.4 kg | 1091.1 lb |
| Stator Discharge Connection | 3 1/2" EUE Box | |
| Stator Inlet Connection | 3 1/2" EUE Box | |
| Pump Number of Stator Elements | 4.00 | |
| Stator Material | Carbon Steel | |
| Stator Material Strength (min.UTS) | 480 MPa | 70,000 psi |
| Stator Elastomer Options | HNH , HNS | |

| ROTOR | Metric | Imperial |
|---|---|------------|
| Rotor Minor Nominal Diameter (D) | 41.6 mm | 1.64 inch |
| Rotor Major Nominal Diameter (D+2E) | 57.1 mm | 2.25 inch |
| Recommended Minimum Tubing Drift Diameter | 59.2 mm | 2.33 inch |
| Rotor Head Diameter | 57.2 mm | 2.25 inch |
| Rotor Max Orbit Diameter | 73.2 mm | 2.88 inch |
| Rotor Total Length | 16.11 m | 52.87 ft |
| Rotor Helix Length | 15.90 m | 52.18 ft |
| Rotor Weight | 170.08 kg | 374.64 lb |
| Rotor Head Connection | 1 1/8" API Pin | |
| Recommended Rotor Coupling OD | 57.2 mm | 2.25 inch |
| Rotor Material | Alloy Steel | |
| Rotor Material Strength (min.UTS) | 585 MPa | 85,000 psi |
| Rotor Coating Options | Hard Chrome | |
| ROTOR SPACE OUT OPTIONS | | |
| Rotor Top Landing Device | Top Tag | |
| Rotor Bottom Landing Device | Standard, Extended - Blind/ Slotted/ Notched Tag Nipple | |
| Bottom Landing Device Connection (Inlet) | 3 1/2 EUE Pin | |



FLOWRISE PCP CURVES - 90K1600 RG

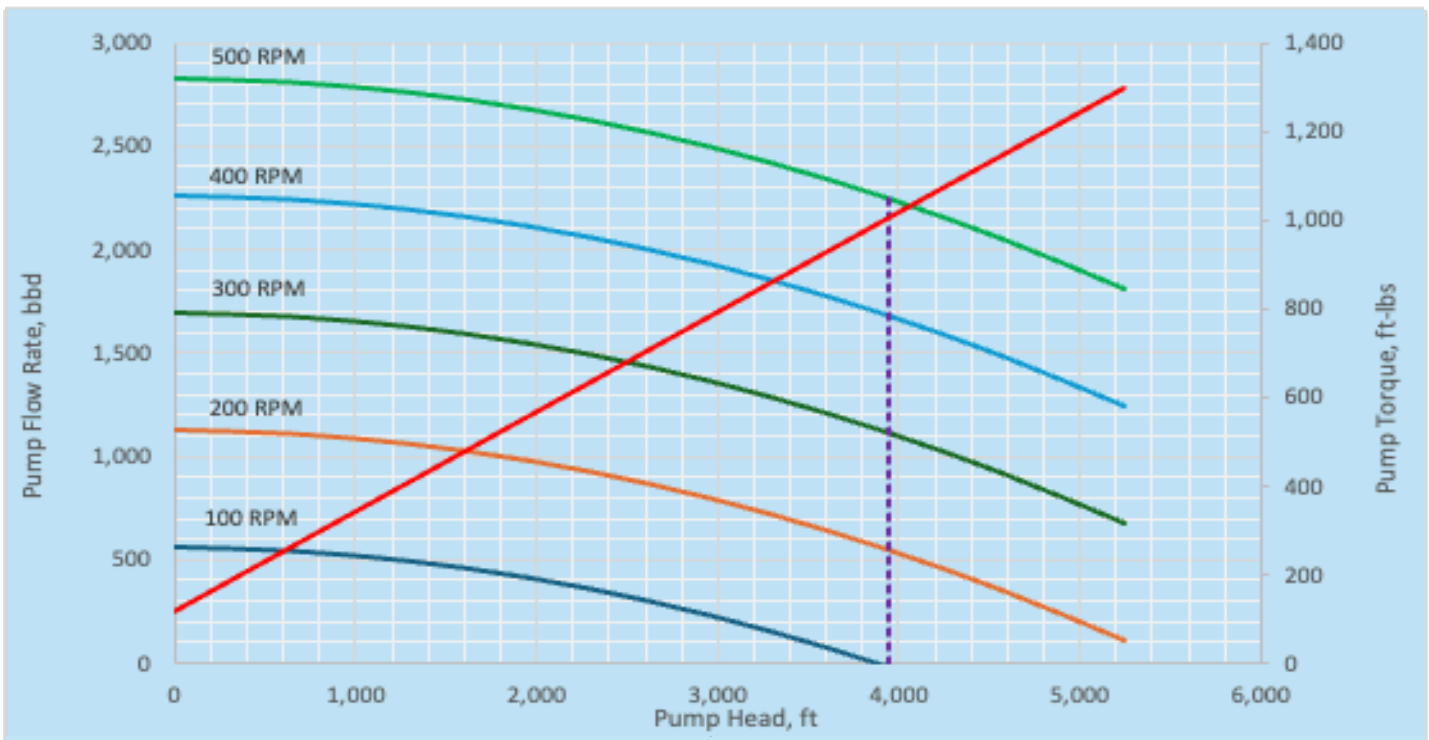
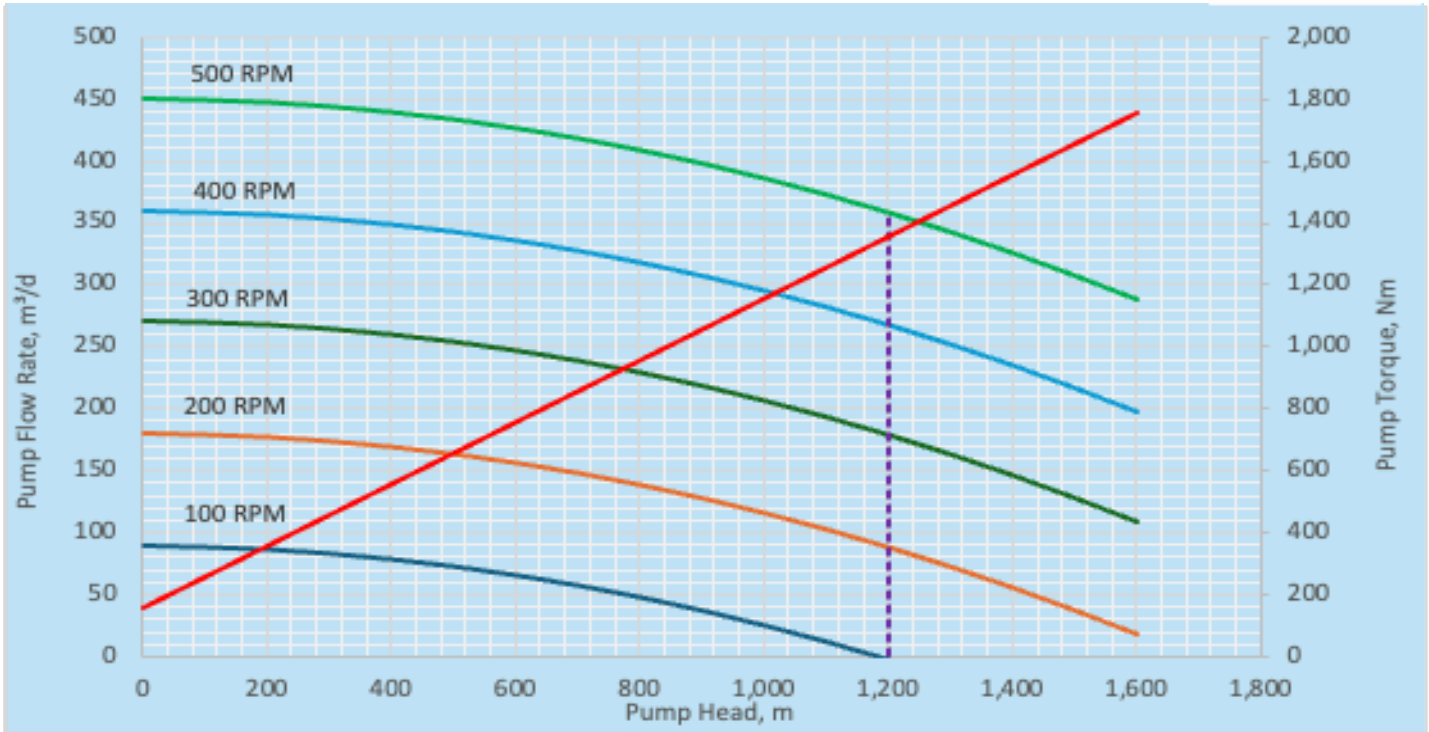

FLOWRISE PCP DATA SHEET

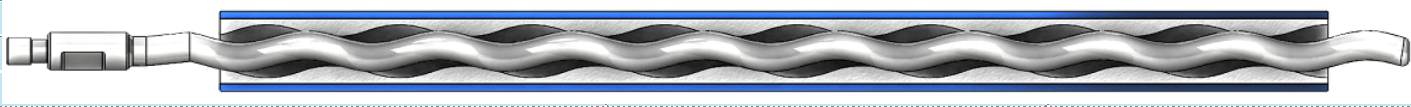
| PUMP | Metric | Imperial |
|---|--|----------------|
| Pump Model | 100K800 RG | |
| Pump Pressure Rating* | 8,000 kPa | 1,160 psi |
| Pump Nominal Capacity | 1.00 m ³ /d/RPM | 6.29 bbl/d/RPM |
| Pump Validated Capacity | 0.98 m ³ /d/RPM | 6.17 bbl/d/RPM |
| Pump Recommended Maximum Speed** | 500 RPM | |
| PUMP DISCHARGE | | PUMP INTAKE |
|  | | |
| STATOR | Metric | Imperial |
| Stator Type | RG | |
| Stator Assembly Max. O.D. | 120.7 mm | 4.75 inch |
| Recommended Minimum Casing Drift Diameter | 124.7 mm | 4.91 inch |
| Recommended Stator Transition Joint Min I.D.**** | N/A | N/A |
| Stator Length**** | 5.76 m | 18.90 ft |
| Stator Weight | 188.6 kg | 415.5 lb |
| Stator Discharge Connection | 4" NU Pin | |
| Stator Inlet Connection | 4" NU Pin | |
| Pump Number of Stator Elements | 2.00 | |
| Stator Material | Carbon Steel | |
| Stator Material Strength (min.UTS) | 480 MPa | 70,000 psi |
| Stator Elastomer Options | HNH , HNS , FKM | |
| ROTOR | Metric | Imperial |
| Rotor Minor Nominal Diameter (D) | 39.6 mm | 1.56 inch |
| Rotor Major Nominal Diameter (D+2E) | 58.9 mm | 2.32 inch |
| Recommended Minimum Tubing Drift Diameter | 60.9 mm | 2.40 inch |
| Rotor Head Diameter | 57.2 mm | 2.25 inch |
| Rotor Max Orbit Diameter | 78.4 mm | 3.09 inch |
| Rotor Total Length | 6.28 m | 20.59 ft |
| Rotor Helix Length | 6.06 m | 19.90 ft |
| Rotor Weight | 60.82 kg | 133.97 lb |
| Rotor Head Connection | 1 1/8" API Pin | |
| Recommended Rotor Coupling OD | 57.2 mm | 2.25 inch |
| Rotor Material | Alloy Steel | |
| Rotor Material Strength (min.UTS) | 585 MPa | 85,000 psi |
| Rotor Coating Options | Hard Chrome | |
| ROTOR SPACE OUT OPTIONS | | |
| Rotor Top Landing Device | Top Tag | |
| Rotor Bottom Landing Device | Standard, Extended - Blind/ Slotted/ Notched Tag Sub | |
| Bottom Landing Device Connection (Inlet) | 3 1/2 EUE Pin / 4 NU Pin | |

FLOWRISE PCP CURVES - 100K800 RG

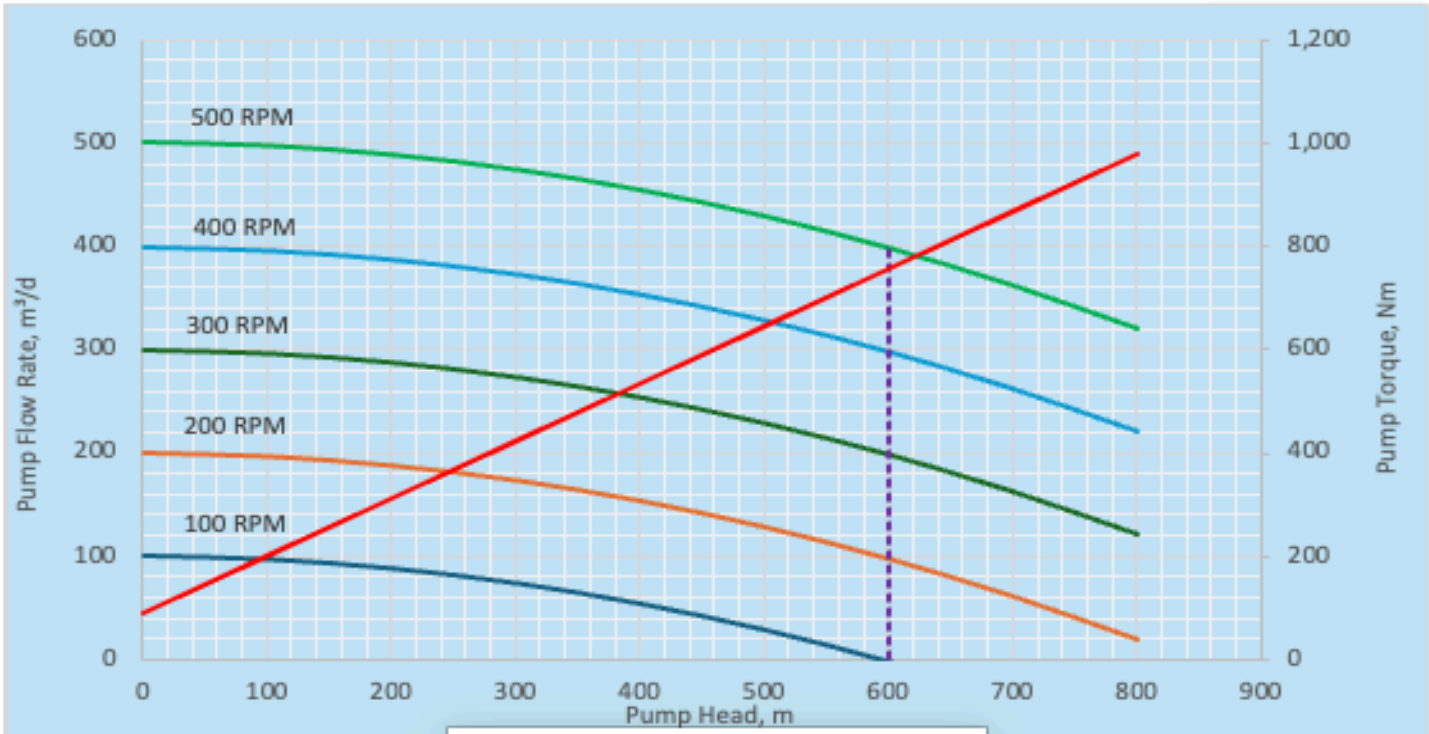

Horizontal (Value) Axis Minor Gridlines

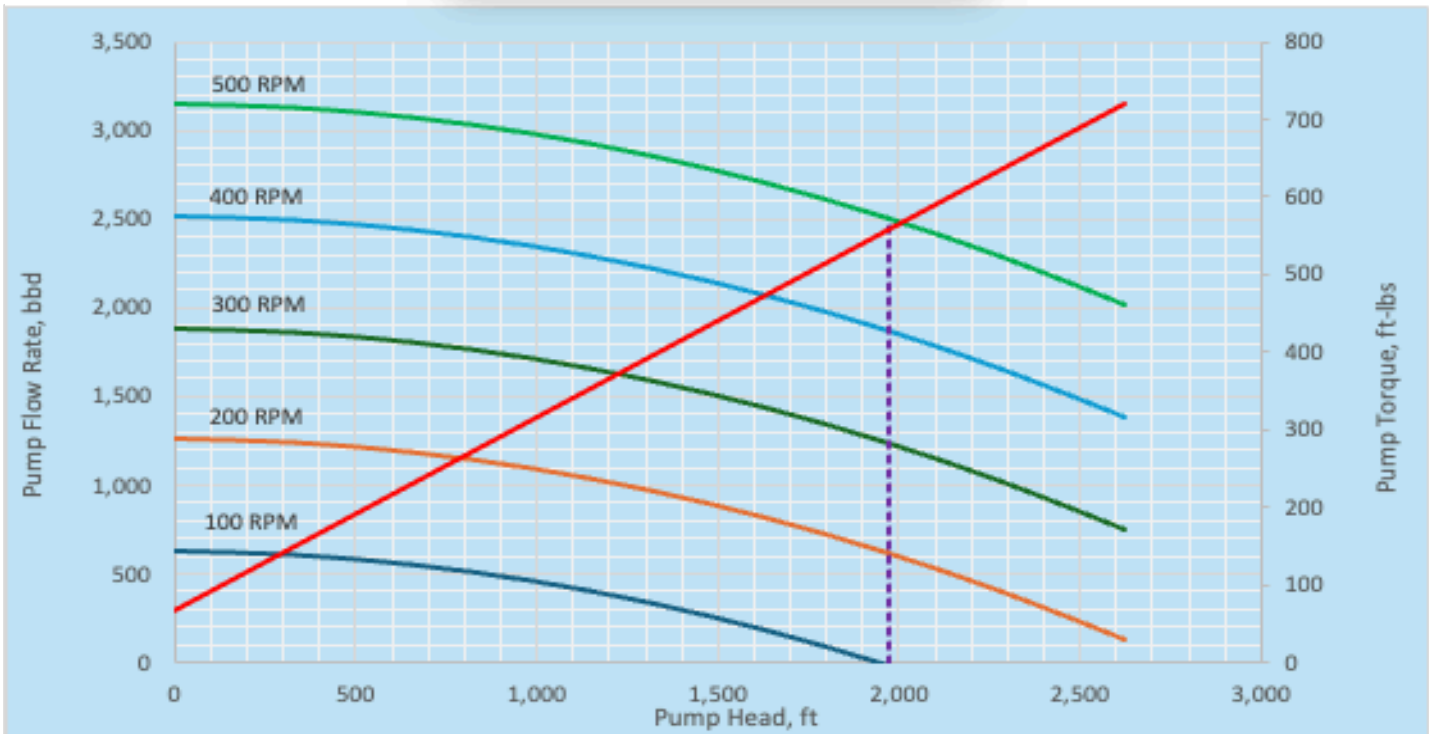

FLOWRISE PCP DATA SHEET

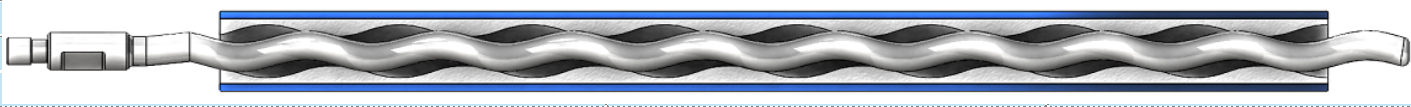
| PUMP | Metric | Imperial |
|---|--|----------------|
| Pump Model | 100K1200 RG | |
| Pump Pressure Rating* | 12,000 kPa | 1,740 psi |
| Pump Nominal Capacity | 1.00 m ³ /d/RPM | 6.29 bbl/d/RPM |
| Pump Validated Capacity | 0.98 m ³ /d/RPM | 6.17 bbl/d/RPM |
| Pump Recommended Maximum Speed** | 500 RPM | |
| PUMP DISCHARGE | | PUMP INTAKE |
|  | | |
| STATOR | Metric | Imperial |
| Stator Type | RG | |
| Stator Assembly Max. O.D. | 120.7 mm | 4.75 inch |
| Recommended Minimum Casing Drift Diameter | 124.7 mm | 4.91 inch |
| Recommended Stator Transition Joint Min I.D.**** | N/A | N/A |
| Stator Length**** | 8.64 m | 28.35 ft |
| Stator Weight | 283.0 kg | 623.3 lb |
| Stator Discharge Connection | 4" NU Pin | |
| Stator Inlet Connection | 4" NU Pin | |
| Pump Number of Stator Elements | 3.00 | |
| Stator Material | Carbon Steel | |
| Stator Material Strength (min.UTS) | 480 MPa | 70,000 psi |
| Stator Elastomer Options | HNH , HNS , FKM | |
| ROTOR | Metric | Imperial |
| Rotor Minor Nominal Diameter (D) | 39.6 mm | 1.56 inch |
| Rotor Major Nominal Diameter (D+2E) | 58.9 mm | 2.32 inch |
| Recommended Minimum Tubing Drift Diameter | 60.9 mm | 2.40 inch |
| Rotor Head Diameter | 57.2 mm | 2.25 inch |
| Rotor Max Orbit Diameter | 78.4 mm | 3.09 inch |
| Rotor Total Length | 9.16 m | 30.04 ft |
| Rotor Helix Length | 8.94 m | 29.35 ft |
| Rotor Weight | 88.35 kg | 194.60 lb |
| Rotor Head Connection | 1 1/8" API Pin | |
| Recommended Rotor Coupling OD | 57.2 mm | 2.25 inch |
| Rotor Material | Alloy Steel | |
| Rotor Material Strength (min.UTS) | 585 MPa | 85,000 psi |
| Rotor Coating Options | Hard Chrome | |
| ROTOR SPACE OUT OPTIONS | | |
| Rotor Top Landing Device | Top Tag | |
| Rotor Bottom Landing Device | Standard, Extended - Blind/ Slotted/ Notched Tag Sub | |
| Bottom Landing Device Connection (Inlet) | 3 1/2 EUE Pin / 4 NU Pin | |



FLOWRISE PCP CURVES - 100K1200 RG

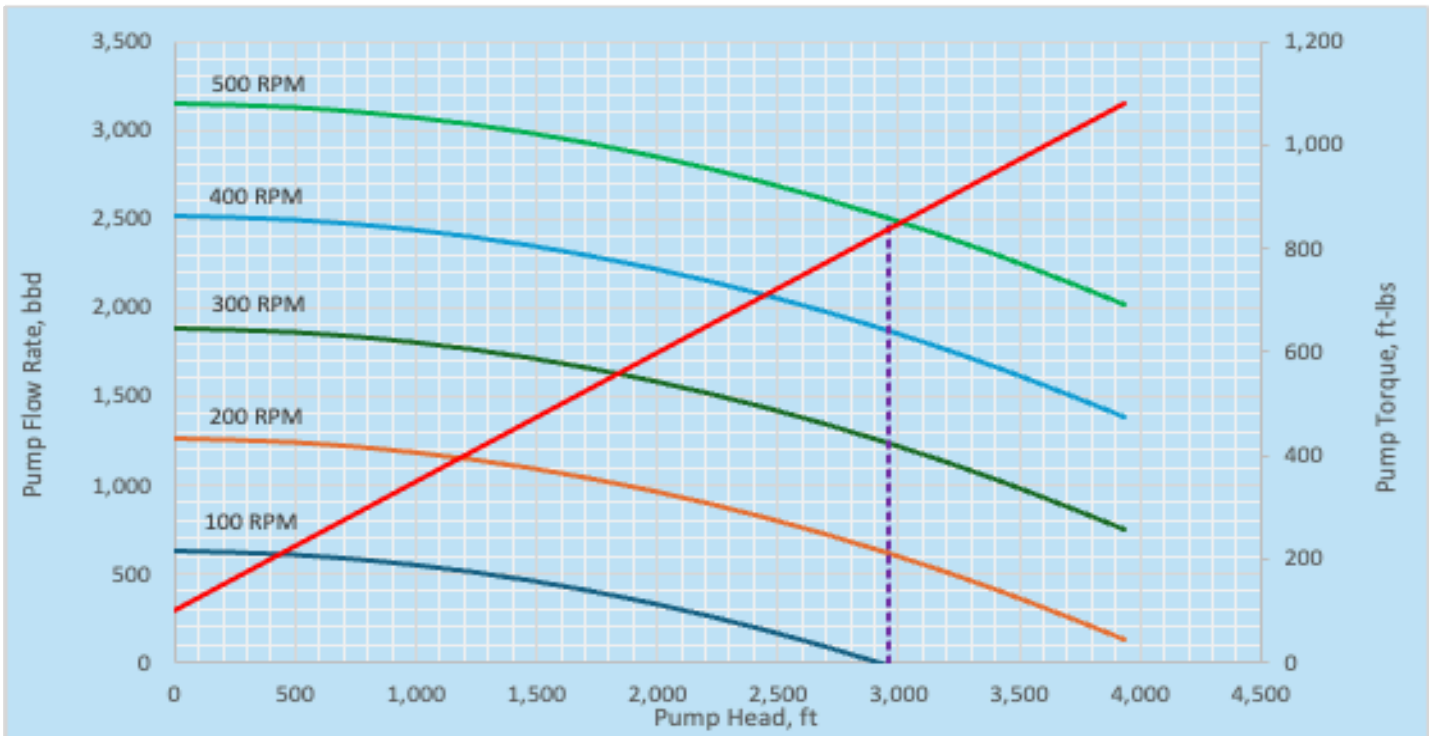
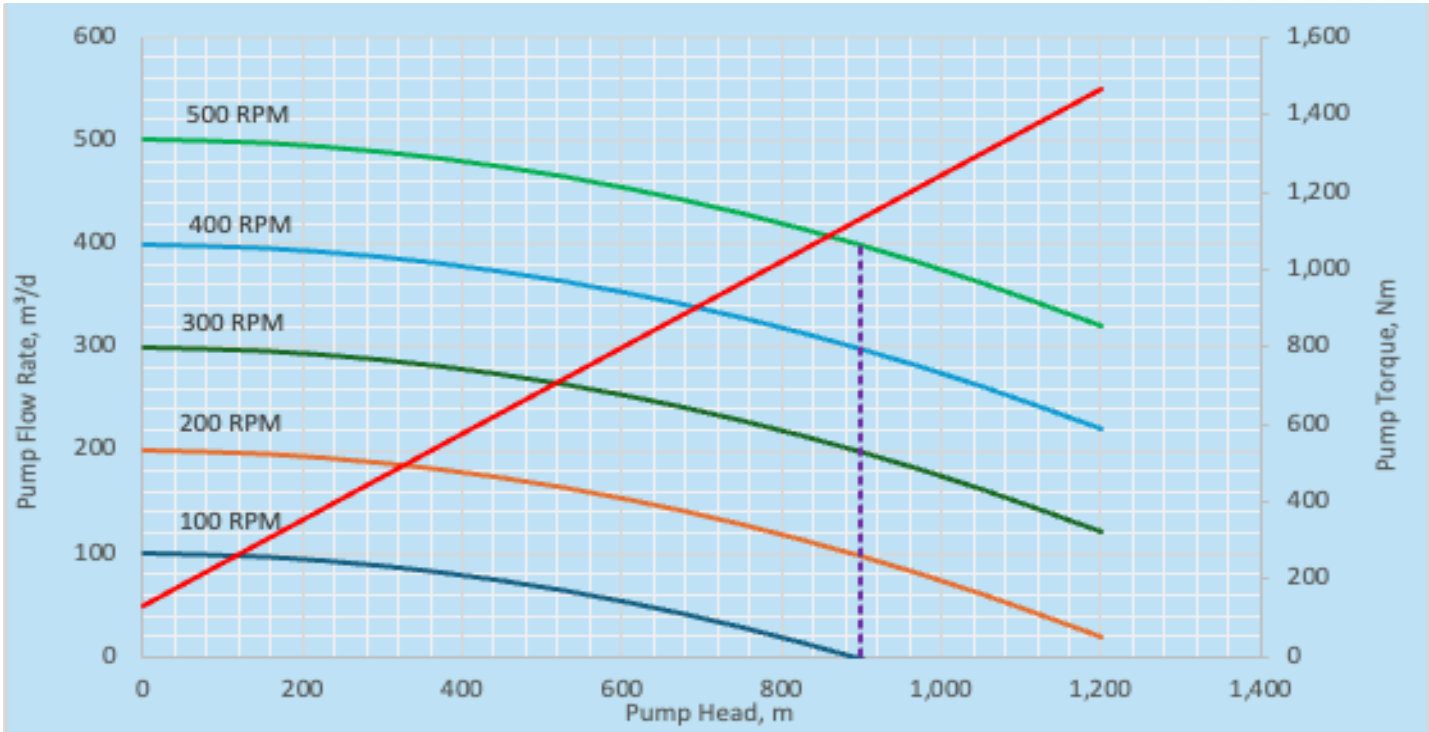

FLOWRISE PCP DATA SHEET

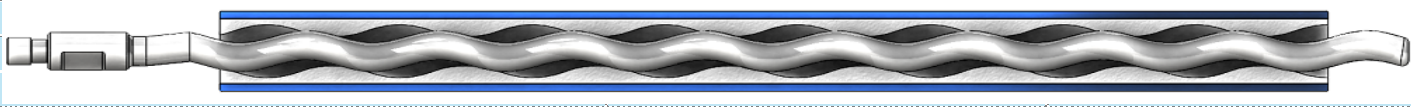
| PUMP | Metric | Imperial |
|---|--|----------------|
| Pump Model | 100K1800 RG | |
| Pump Pressure Rating* | 18,000 kPa | 2,610 psi |
| Pump Nominal Capacity | 1.00 m ³ /d/RPM | 6.29 bbl/d/RPM |
| Pump Validated Capacity | 0.98 m ³ /d/RPM | 6.17 bbl/d/RPM |
| Pump Recommended Maximum Speed** | 500 RPM | |
| PUMP DISCHARGE | | PUMP INTAKE |
|  | | |
| STATOR | Metric | Imperial |
| Stator Type | RG | |
| Stator Assembly Max. O.D. | 120.7 mm | 4.75 inch |
| Recommended Minimum Casing Drift Diameter | 124.7 mm | 4.91 inch |
| Recommended Stator Transition Joint Min I.D.**** | N/A | N/A |
| Stator Length**** | 12.96 m | 42.52 ft |
| Stator Weight | 424.4 kg | 934.9 lb |
| Stator Discharge Connection | 4" NU Pin | |
| Stator Inlet Connection | 4" NU Pin | |
| Pump Number of Stator Elements | 4.50 | |
| Stator Material | Carbon Steel | |
| Stator Material Strength (min.UTS) | 480 MPa | 70,000 psi |
| Stator Elastomer Options | HNH , HNS , FKM | |
| ROTOR | Metric | Imperial |
| Rotor Minor Nominal Diameter (D) | 39.6 mm | 1.56 inch |
| Rotor Major Nominal Diameter (D+2E) | 58.9 mm | 2.32 inch |
| Recommended Minimum Tubing Drift Diameter | 60.9 mm | 2.40 inch |
| Rotor Head Diameter | 57.2 mm | 2.25 inch |
| Rotor Max Orbit Diameter | 78.4 mm | 3.09 inch |
| Rotor Total Length | 13.47 m | 44.21 ft |
| Rotor Helix Length | 13.26 m | 43.52 ft |
| Rotor Weight | 129.63 kg | 285.54 lb |
| Rotor Head Connection | 1 1/8" API Pin | |
| Recommended Rotor Coupling OD | 57.2 mm | 2.25 inch |
| Rotor Material | Alloy Steel | |
| Rotor Material Strength (min.UTS) | 585 MPa | 85,000 psi |
| Rotor Coating Options | Hard Chrome | |
| ROTOR SPACE OUT OPTIONS | | |
| Rotor Top Landing Device | Top Tag | |
| Rotor Bottom Landing Device | Standard, Extended - Blind/ Slotted/ Notched Tag Sub | |
| Bottom Landing Device Connection (Inlet) | 3 1/2 EUE Pin / 4 NU Pin | |



FLOWRISE PCP CURVES - 100K1800 RG

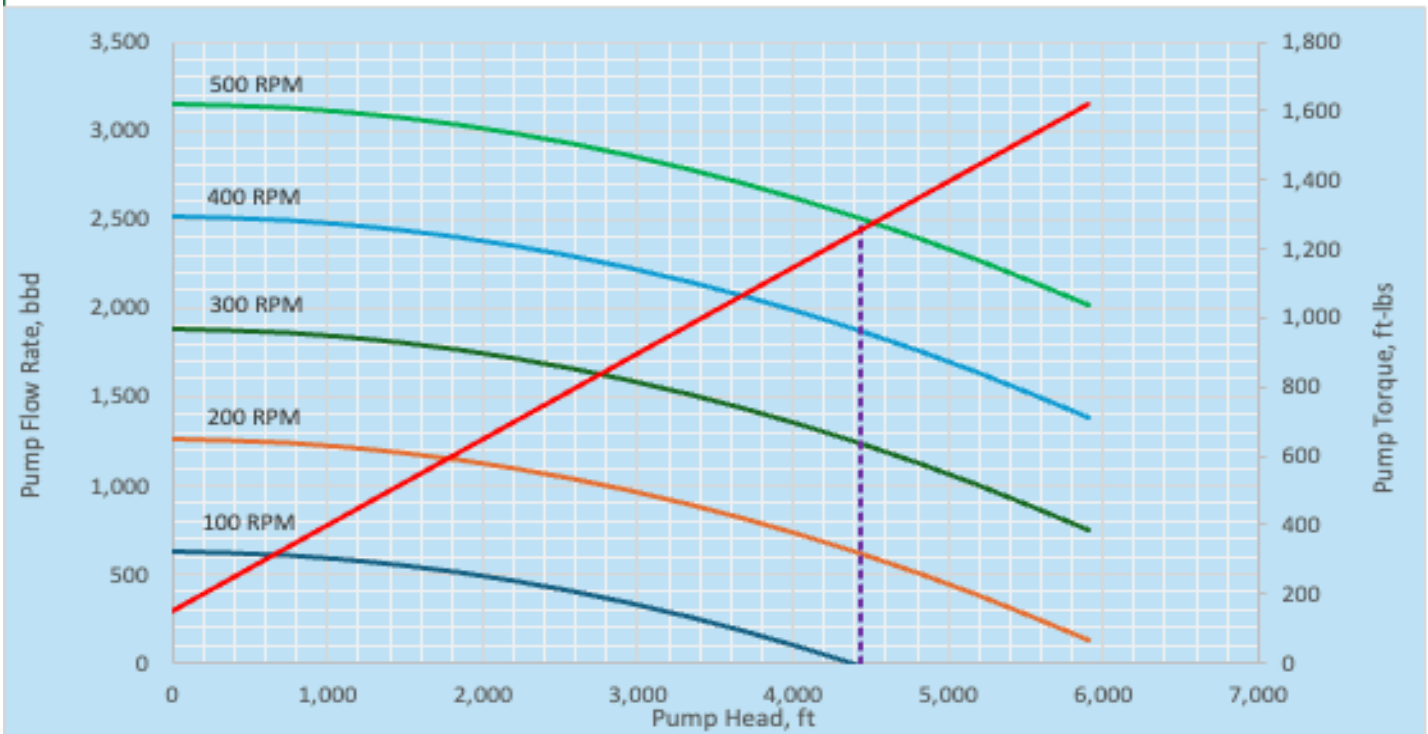
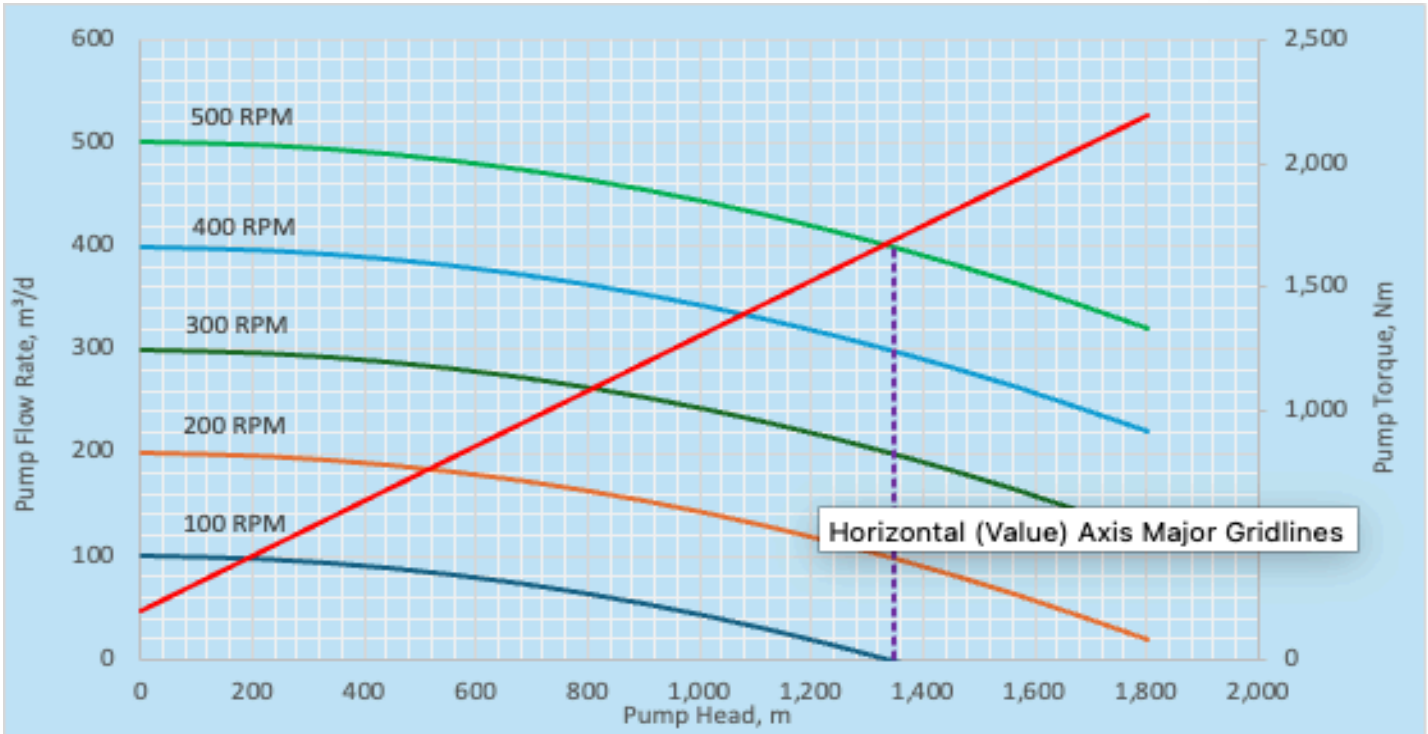

FLOWRISE PCP DATA SHEET

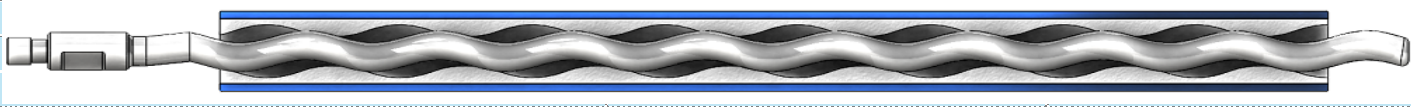
| PUMP | Metric | Imperial |
|---|-----------------------------------|----------------|
| Pump Model | 150K800 RG | |
| Pump Pressure Rating* | 8,000 kPa | 1,160 psi |
| Pump Nominal Capacity | 1.50 m ³ /d/RPM | 9.44 bbl/d/RPM |
| Pump Validated Capacity | 1.53 m ³ /d/RPM | 9.63 bbl/d/RPM |
| Pump Recommended Maximum Speed** | 300 RPM | |
| PUMP DISCHARGE | | PUMP INTAKE |
|  | | |
| STATOR | Metric | Imperial |
| Stator Type | RG | |
| Stator Assembly Max. O.D. | 141.3 mm | 5.56 inch |
| Recommended Minimum Casing Drift Diameter | 145.3 mm | 5.72 inch |
| Recommended Stator Transition Joint Min I.D.**** | N/A | N/A |
| Stator Length**** | 5.66 m | 18.57 ft |
| Stator Weight | 284.0 kg | 625.6 lb |
| Stator Discharge Connection | 5" Casing Short Pin | |
| Stator Inlet Connection | 5" Casing Short Pin | |
| Pump Number of Stator Elements | 2.00 | |
| Stator Material | Carbon Steel | |
| Stator Material Strength (min.UTS) | 480 MPa | 70,000 psi |
| Stator Elastomer Options | HNH | |
| ROTOR | Metric | Imperial |
| Rotor Minor Nominal Diameter (D) | 51.3 mm | 2.02 inch |
| Rotor Major Nominal Diameter (D+2E) | 76.5 mm | 3.01 inch |
| Recommended Minimum Tubing Drift Diameter | 78.5 mm | 3.09 inch |
| Rotor Head Diameter | 57.2 mm | 2.25 inch |
| Rotor Max Orbit Diameter | 102.5 mm | 4.04 inch |
| Rotor Total Length | 6.18 m | 20.26 ft |
| Rotor Helix Length | 5.96 m | 19.57 ft |
| Rotor Weight | 100.77 kg | 221.96 lb |
| Rotor Head Connection | 1 1/8" API Pin | |
| Recommended Rotor Coupling OD | 57.2 mm | 2.25 inch |
| Rotor Material | Alloy Steel | |
| Rotor Material Strength (min.UTS) | 585 MPa | 85,000 psi |
| Rotor Coating Options | Hard Chrome | |
| ROTOR SPACE OUT OPTIONS | | |
| Rotor Top Landing Device | N/A | |
| Rotor Bottom Landing Device | Standard - Blind/ Slotted Tag Sub | |
| Bottom Landing Device Connection (Inlet) | 4 NU Pin / 4 1/2 EUE Pin | |



FLOWRISE PCP CURVES - 150K800 RG

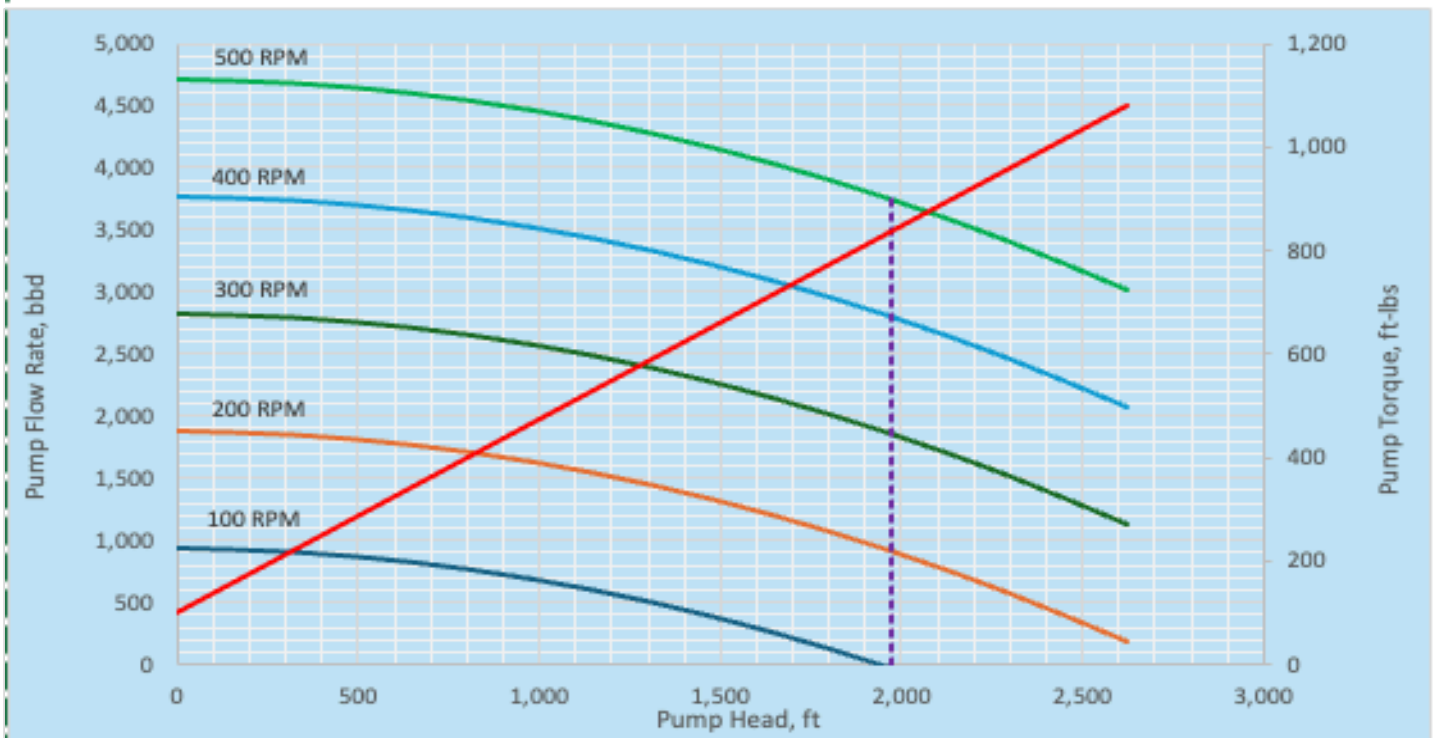
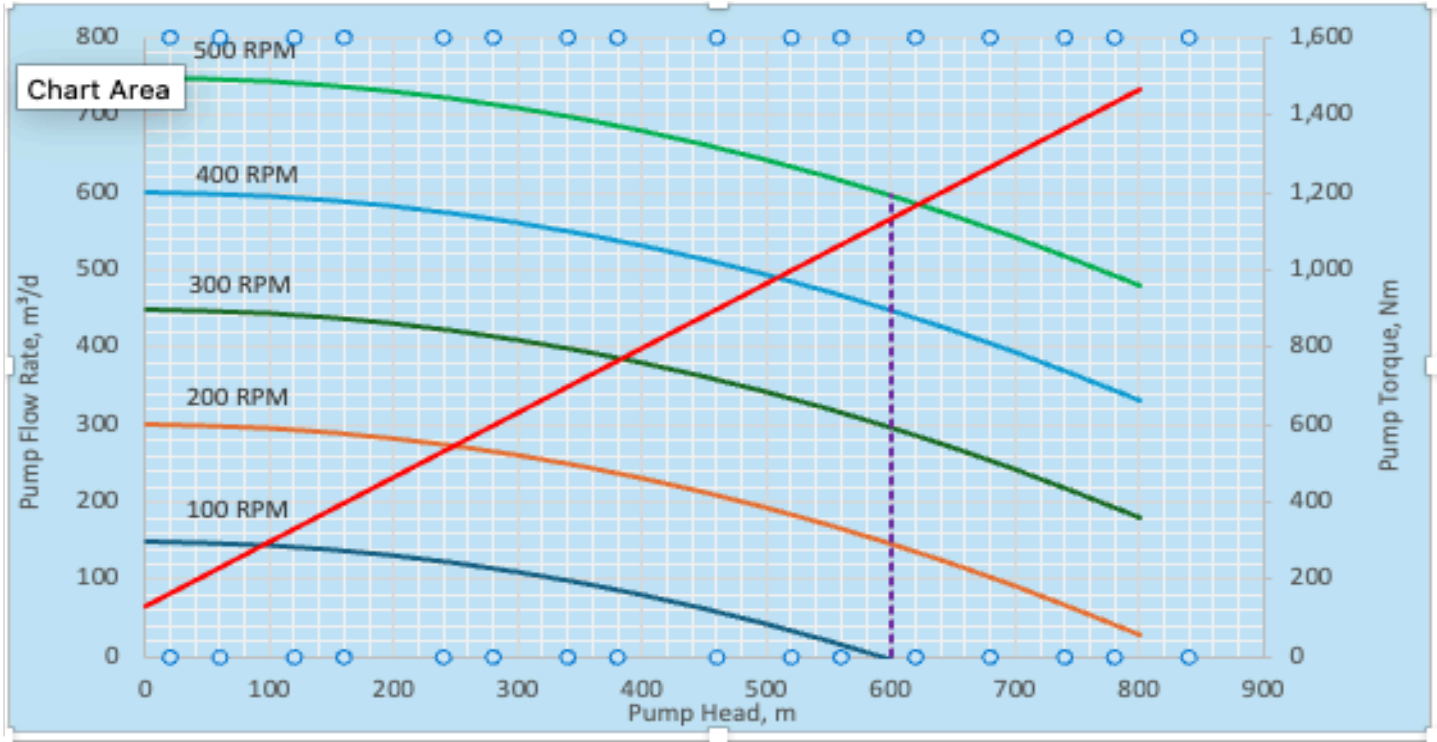

FLOWRISE PCP DATA SHEET

| PUMP | Metric | Imperial |
|----------------------------------|----------------------------|----------------|
| Pump Model | 150K1200 RG | |
| Pump Pressure Rating* | 12,000 kPa | 1,740 psi |
| Pump Nominal Capacity | 1.50 m ³ /d/RPM | 9.44 bbl/d/RPM |
| Pump Validated Capacity | 1.53 m ³ /d/RPM | 9.63 bbl/d/RPM |
| Pump Recommended Maximum Speed** | 300 RPM | |
| PUMP DISCHARGE | | PUMP INTAKE |

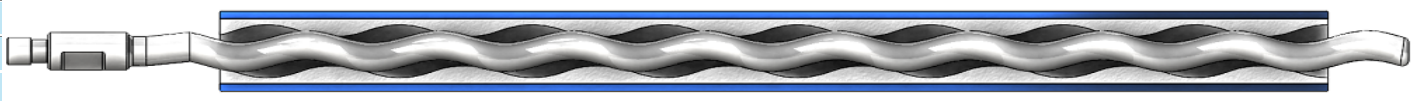

| STATOR | Metric | Imperial |
|--|---------------------|------------|
| Stator Type | RG | |
| Stator Assembly Max. O.D. | 141.3 mm | 5.56 inch |
| Recommended Minimum Casing Drift Diameter | 145.3 mm | 5.72 inch |
| Recommended Stator Transition Joint Min I.D.**** | N/A | N/A |
| Stator Length**** | 8.49 m | 27.85 ft |
| Stator Weight | 426.0 kg | 938.4 lb |
| Stator Discharge Connection | 5" Casing Short Pin | |
| Stator Inlet Connection | 5" Casing Short Pin | |
| Pump Number of Stator Elements | 3.00 | |
| Stator Material | Carbon Steel | |
| Stator Material Strength (min.UTS) | 480 MPa | 70,000 psi |
| Stator Elastomer Options | HNH | |

| ROTOR | Metric | Imperial |
|---|-----------------------------------|------------|
| Rotor Minor Nominal Diameter (D) | 51.3 mm | 2.02 inch |
| Rotor Major Nominal Diameter (D+2E) | 76.5 mm | 3.01 inch |
| Recommended Minimum Tubing Drift Diameter | 78.5 mm | 3.09 inch |
| Rotor Head Diameter | 57.2 mm | 2.25 inch |
| Rotor Max Orbit Diameter | 102.5 mm | 4.04 inch |
| Rotor Total Length | 9.01 m | 29.54 ft |
| Rotor Helix Length | 8.79 m | 28.85 ft |
| Rotor Weight | 146.56 kg | 322.82 lb |
| Rotor Head Connection | 1 1/8" API Pin | |
| Recommended Rotor Coupling OD | 57.2 mm | 2.25 inch |
| Rotor Material | Alloy Steel | |
| Rotor Material Strength (min.UTS) | 585 MPa | 85,000 psi |
| Rotor Coating Options | Hard Chrome | |
| ROTOR SPACE OUT OPTIONS | | |
| Rotor Top Landing Device | N/A | |
| Rotor Bottom Landing Device | Standard - Blind/ Slotted Tag Sub | |
| Bottom Landing Device Connection (Inlet) | 4 NU Pin / 4 1/2 EUE Pin | |



FLOWRISE PCP CURVES - 150K1200 RG

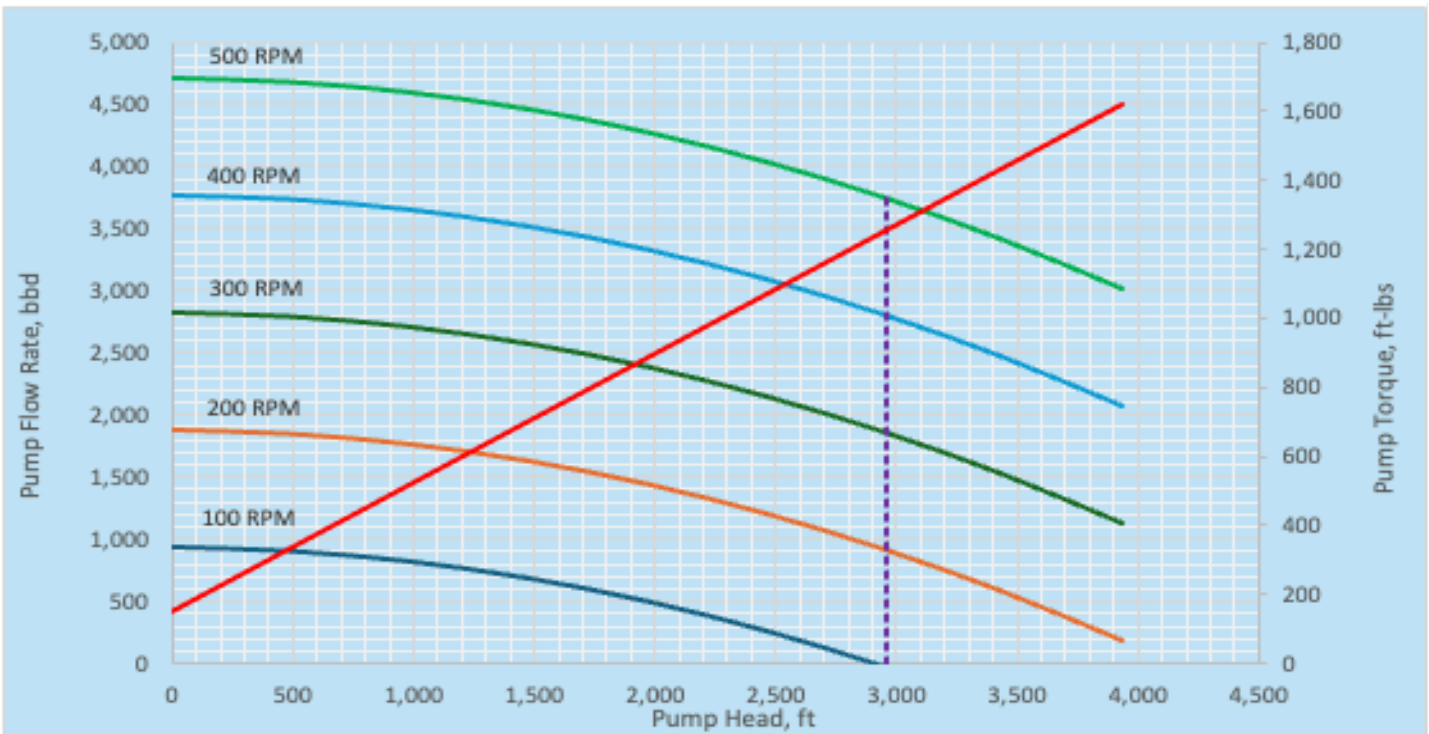
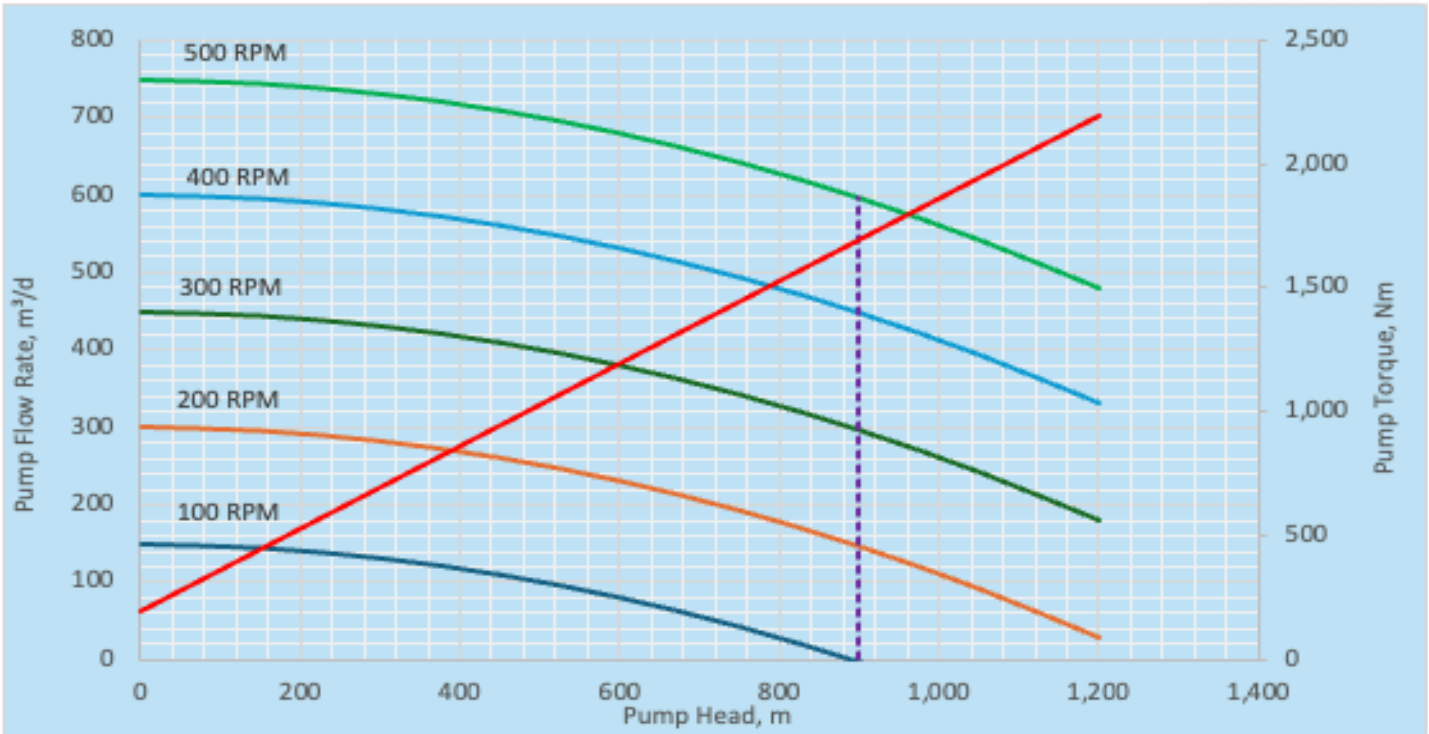

FLOWRISE PCP DATA SHEET

| PUMP | Metric | Imperial |
|----------------------------------|----------------------------|----------------|
| Pump Model | 150K1600 RG | |
| Pump Pressure Rating* | 16,000 kPa | 2,320 psi |
| Pump Nominal Capacity | 1.50 m ³ /d/RPM | 9.44 bbl/d/RPM |
| Pump Validated Capacity | 1.53 m ³ /d/RPM | 9.63 bbl/d/RPM |
| Pump Recommended Maximum Speed** | 300 RPM | |
| PUMP DISCHARGE | | PUMP INTAKE |

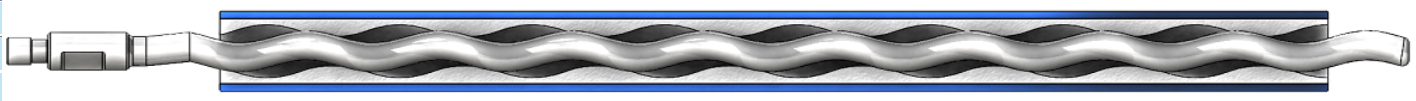

| STATOR | Metric | Imperial |
|--|---------------------|------------|
| Stator Type | RG | |
| Stator Assembly Max. O.D. | 141.3 mm | 5.56 inch |
| Recommended Minimum Casing Drift Diameter | 145.3 mm | 5.72 inch |
| Recommended Stator Transition Joint Min I.D.**** | N/A | N/A |
| Stator Length**** | 11.32 m | 37.14 ft |
| Stator Weight | 568.0 kg | 1251.2 lb |
| Stator Discharge Connection | 5" Casing Short Pin | |
| Stator Inlet Connection | 5" Casing Short Pin | |
| Pump Number of Stator Elements | 4.00 | |
| Stator Material | Carbon Steel | |
| Stator Material Strength (min.UTS) | 480 MPa | 70,000 psi |
| Stator Elastomer Options | HNH | |

| ROTOR | Metric | Imperial |
|---|-----------------------------------|------------|
| Rotor Minor Nominal Diameter (D) | 51.3 mm | 2.02 inch |
| Rotor Major Nominal Diameter (D+2E) | 76.5 mm | 3.01 inch |
| Recommended Minimum Tubing Drift Diameter | 78.5 mm | 3.09 inch |
| Rotor Head Diameter | 57.2 mm | 2.25 inch |
| Rotor Max Orbit Diameter | 102.5 mm | 4.04 inch |
| Rotor Total Length | 11.83 m | 38.83 ft |
| Rotor Helix Length | 11.62 m | 38.14 ft |
| Rotor Weight | 192.35 kg | 423.68 lb |
| Rotor Head Connection | 1 1/8" API Pin | |
| Recommended Rotor Coupling OD | 57.2 mm | 2.25 inch |
| Rotor Material | Alloy Steel | |
| Rotor Material Strength (min.UTS) | 585 MPa | 85,000 psi |
| Rotor Coating Options | Hard Chrome | |
| ROTOR SPACE OUT OPTIONS | | |
| Rotor Top Landing Device | N/A | |
| Rotor Bottom Landing Device | Standard - Blind/ Slotted Tag Sub | |
| Bottom Landing Device Connection (Inlet) | 4 NU Pin / 4 1/2 EUE Pin | |



FLOWRISE PCP CURVES - 150K1600 RG

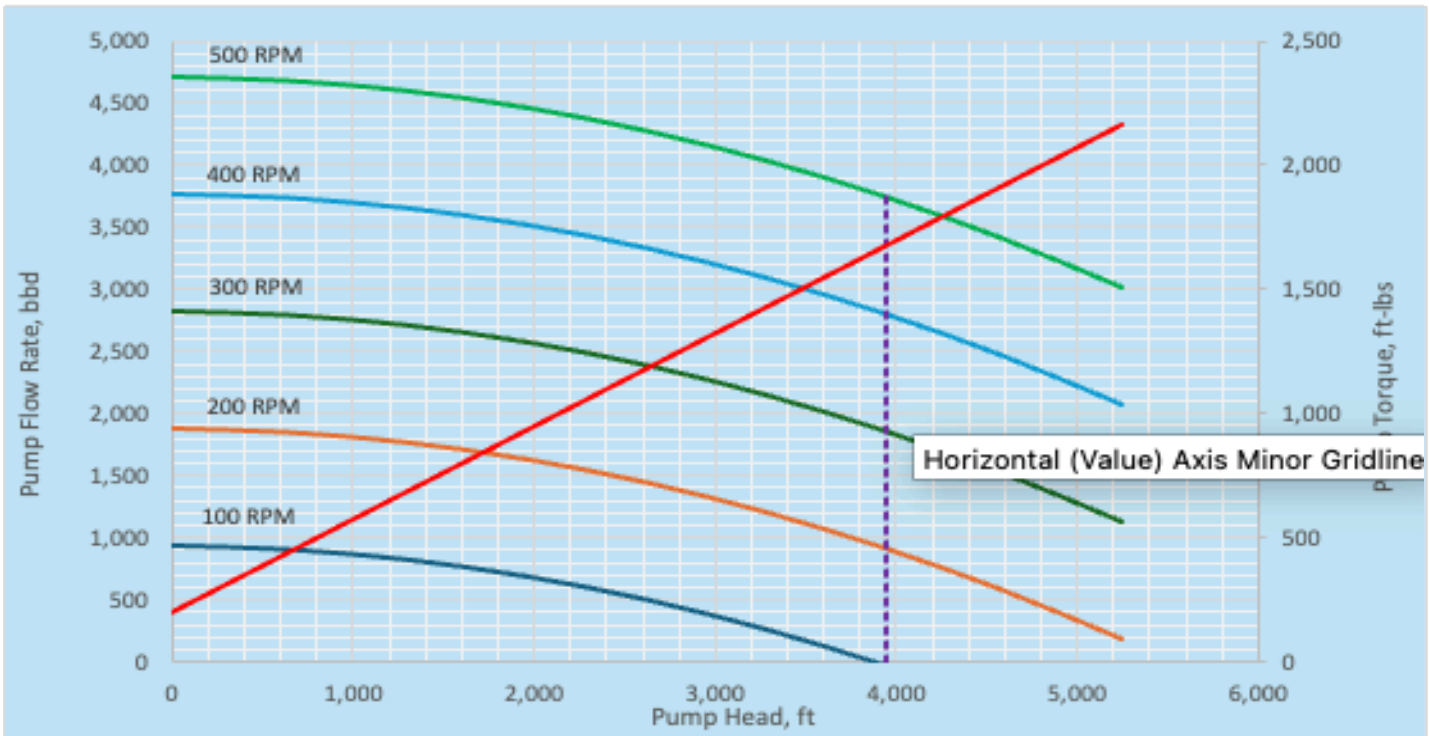
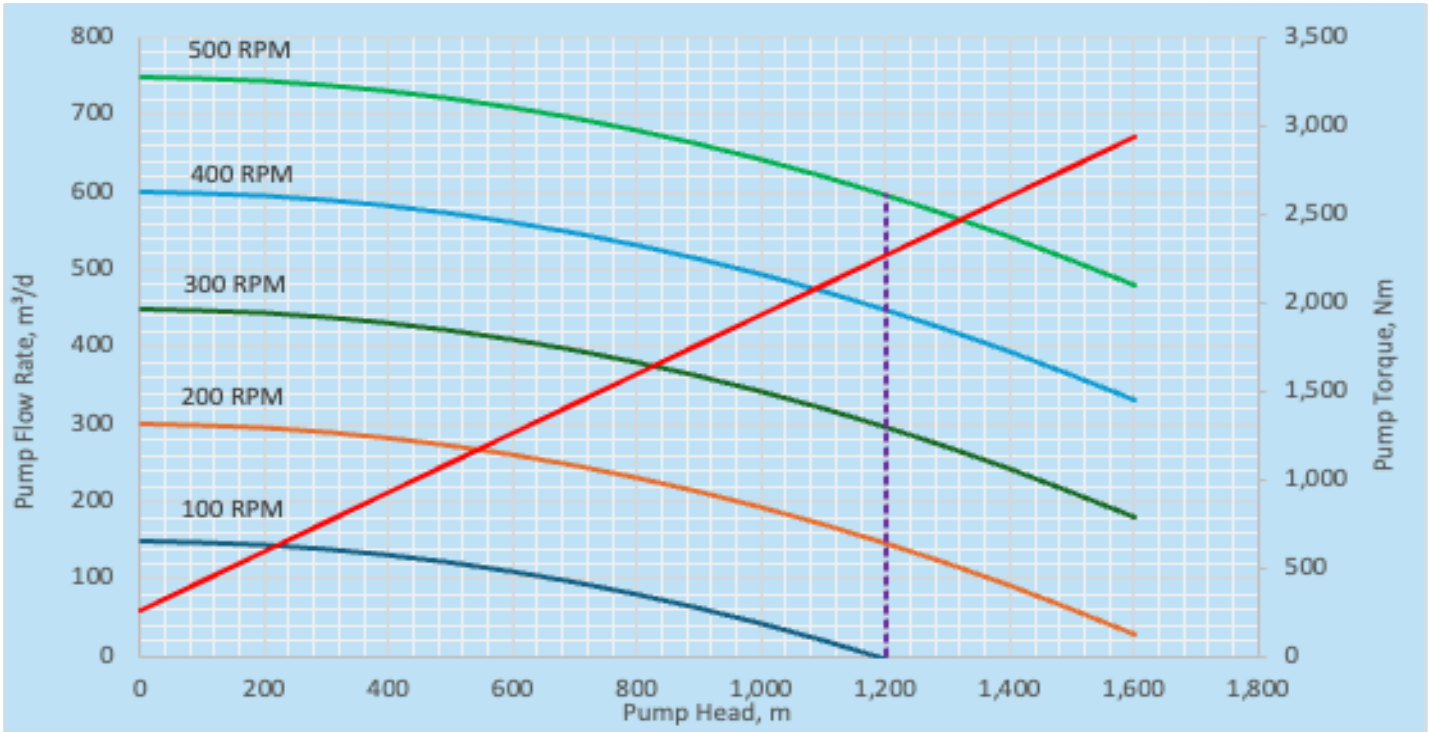

FLOWRISE PCP DATA SHEET

| PUMP | Metric | Imperial |
|----------------------------------|----------------------------|-----------------|
| Pump Model | 205K1000 RG | |
| Pump Pressure Rating* | 10,000 kPa | 1,450 psi |
| Pump Nominal Capacity | 2.05 m ³ /d/RPM | 12.89 bbl/d/RPM |
| Pump Validated Capacity | 2.10 m ³ /d/RPM | 13.23 bbl/d/RPM |
| Pump Recommended Maximum Speed** | 400 RPM | |
| PUMP DISCHARGE | | PUMP INTAKE |

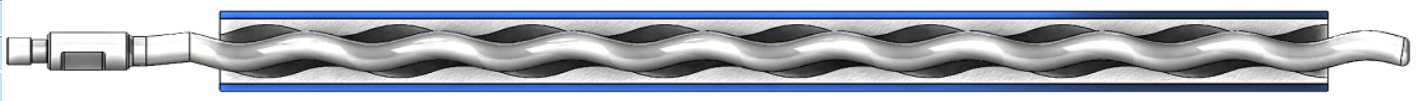

| STATOR | Metric | Imperial |
|--|----------------|------------|
| Stator Type | RG | |
| Stator Assembly Max. O.D. | 141.2 mm | 5.56 inch |
| Recommended Minimum Casing Drift Diameter | 145.2 mm | 5.72 inch |
| Recommended Stator Transition Joint Min I.D.**** | N/A | N/A |
| Stator Length**** | 11.80 m | 38.71 ft |
| Stator Weight | 470.6 kg | 1036.5 lb |
| Stator Discharge Connection | 4 1/2" EUE Pin | |
| Stator Inlet Connection | 4 1/2" EUE Pin | |
| Pump Number of Stator Elements | 4.00 | |
| Stator Material | Carbon Steel | |
| Stator Material Strength (min.UTS) | 480 MPa | 70,000 psi |
| Stator Elastomer Options | HNH | |

| ROTOR | Metric | Imperial |
|---|-----------------------------------|------------|
| Rotor Minor Nominal Diameter (D) | 47.0 mm | 1.85 inch |
| Rotor Major Nominal Diameter (D+2E) | 69.2 mm | 2.72 inch |
| Recommended Minimum Tubing Drift Diameter | 71.2 mm | 2.80 inch |
| Rotor Head Diameter | 57.2 mm | 2.25 inch |
| Rotor Max Orbit Diameter | 91.4 mm | 3.60 inch |
| Rotor Total Length | 11.99 m | 39.33 ft |
| Rotor Helix Length | 11.89 m | 39.02 ft |
| Rotor Weight | 161.80 kg | 356.39 lb |
| Rotor Head Connection | 1 1/8" API Pin | |
| Recommended Rotor Coupling OD | 57.2 mm | 2.25 inch |
| Rotor Material | Alloy Steel | |
| Rotor Material Strength (min.UTS) | 585 MPa | 85,000 psi |
| Rotor Coating Options | Hard Chrome | |
| ROTOR SPACE OUT OPTIONS | | |
| Rotor Top Landing Device | N/A | |
| Rotor Bottom Landing Device | Standard - Blind/ Slotted Tag Sub | |
| Bottom Landing Device Connection (Inlet) | 4 1/2 EUE Pin | |



FLOWRISE PCP CURVES - 205K1000 RG

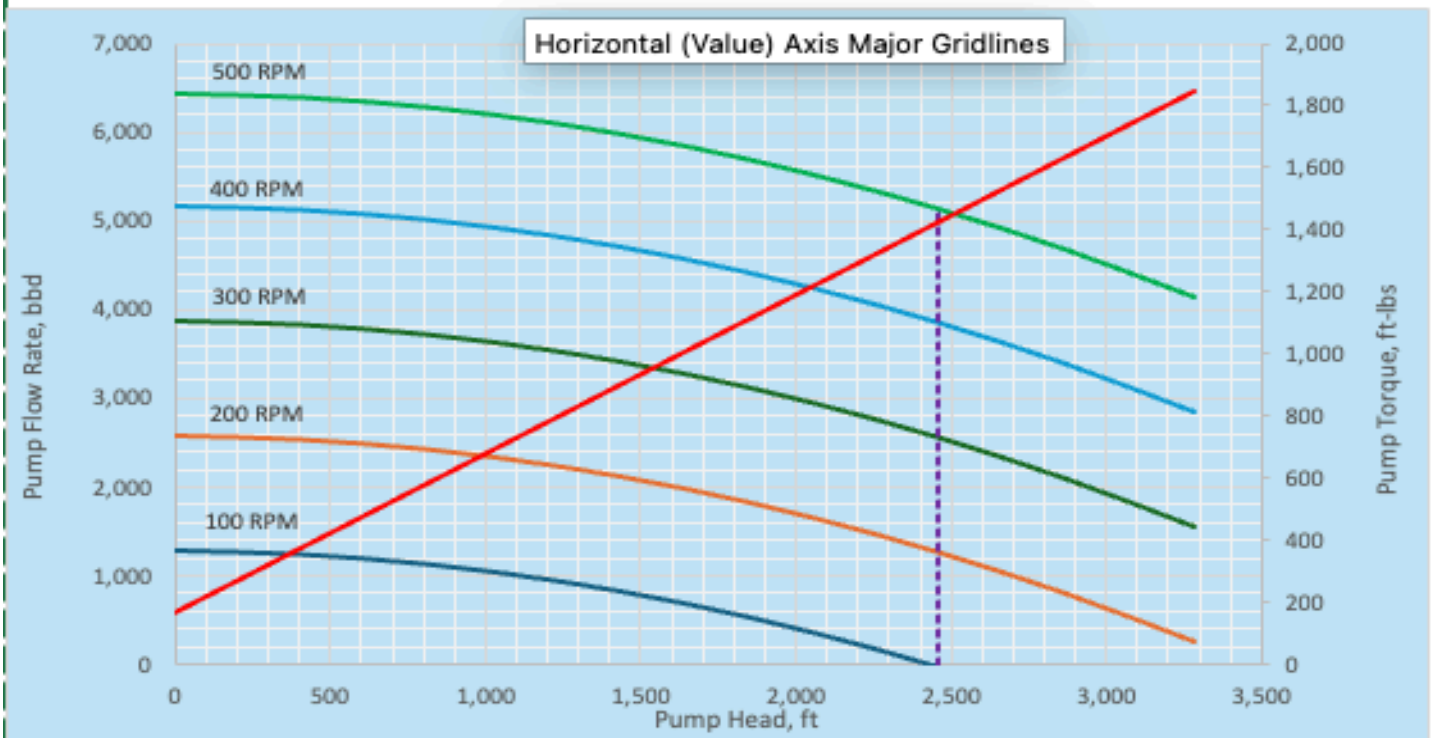
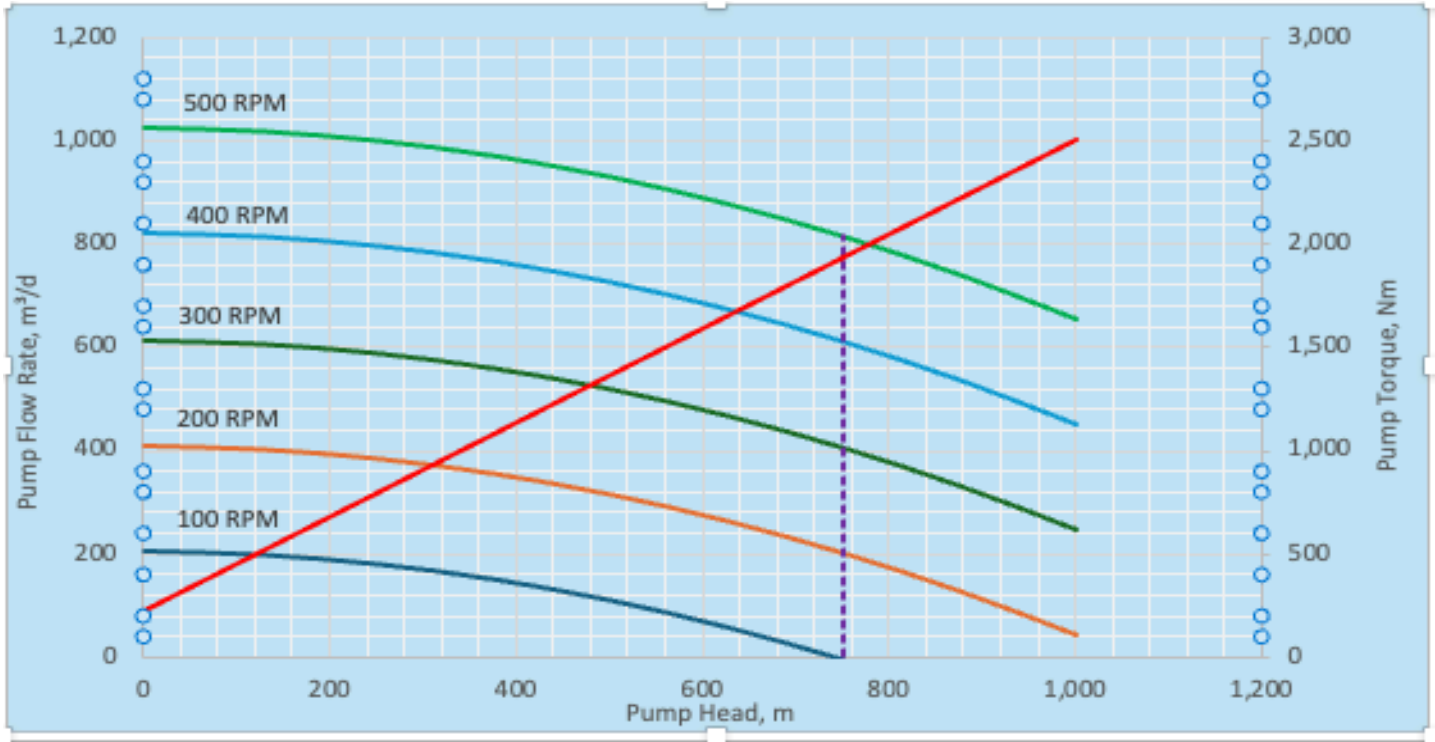

FLOWRISE PCP DATA SHEET

| PUMP | Metric | Imperial |
|----------------------------------|----------------------------|-----------------|
| Pump Model | 303K800 RG | |
| Pump Pressure Rating* | 8,000 kPa | 1,160 psi |
| Pump Nominal Capacity | 3.03 m ³ /d/RPM | 19.06 bbl/d/RPM |
| Pump Validated Capacity | 3.02 m ³ /d/RPM | 18.99 bbl/d/RPM |
| Pump Recommended Maximum Speed** | 300 RPM | |
| PUMP DISCHARGE | | PUMP INTAKE |

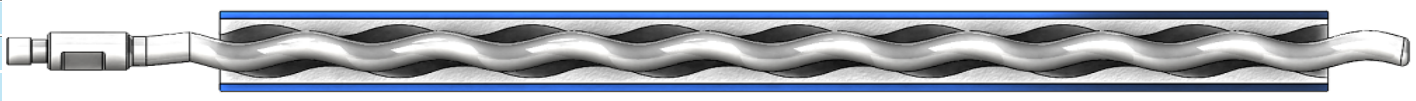

| STATOR | Metric | Imperial |
|--|----------------|------------|
| Stator Type | RG | |
| Stator Assembly Max. O.D. | 141.2 mm | 5.56 inch |
| Recommended Minimum Casing Drift Diameter | 145.2 mm | 5.72 inch |
| Recommended Stator Transition Joint Min I.D.**** | N/A | N/A |
| Stator Length**** | 11.60 m | 38.06 ft |
| Stator Weight | 409.0 kg | 900.8 lb |
| Stator Discharge Connection | 4 1/2" EUE Pin | |
| Stator Inlet Connection | 4 1/2" EUE Pin | |
| Pump Number of Stator Elements | 4.00 | |
| Stator Material | Carbon Steel | |
| Stator Material Strength (min.UTS) | 480 MPa | 70,000 psi |
| Stator Elastomer Options | HNH | |

| ROTOR | Metric | Imperial |
|---|-----------------------------------|------------|
| Rotor Minor Nominal Diameter (D) | 48.0 mm | 1.89 inch |
| Rotor Major Nominal Diameter (D+2E) | 72.0 mm | 2.83 inch |
| Recommended Minimum Tubing Drift Diameter | 74.0 mm | 2.91 inch |
| Rotor Head Diameter | 57.2 mm | 2.25 inch |
| Rotor Max Orbit Diameter | 96.0 mm | 3.78 inch |
| Rotor Total Length | 11.99 m | 39.33 ft |
| Rotor Helix Length | 11.69 m | 38.37 ft |
| Rotor Weight | 168.47 kg | 371.08 lb |
| Rotor Head Connection | 1 1/8" API Pin | |
| Recommended Rotor Coupling OD | 57.2 mm | 2.25 inch |
| Rotor Material | Alloy Steel | |
| Rotor Material Strength (min.UTS) | 585 MPa | 85,000 psi |
| Rotor Coating Options | Hard Chrome | |
| ROTOR SPACE OUT OPTIONS | | |
| Rotor Top Landing Device | N/A | |
| Rotor Bottom Landing Device | Standard - Blind/ Slotted Tag Sub | |
| Bottom Landing Device Connection (Inlet) | 4 1/2 EUE Pin | |



FLOWRISE PCP CURVES - 303K800 RG

